

Radiant **GUARD**

Protecting Your Energy Costs

Installation for Side Walls

2" X 4" With R-13 Un-faced (Assembly R-Value 16.0)

2" X 6" With R-19 Un-faced (Assembly R-Value 22.0)

Please read and follow all of the steps below to ensure proper installation.

Note: Upon receipt of your radiant barrier, store in a dry covered location; leaving the barrier exposed to the outdoor elements can cause the aluminum to corrode and potentially reduce its effectiveness at blocking the maximum amount of radiant heat possible.

Products Suggested:

- Radiant GUARD™ **FOIL** or **WHITE Bubble** radiant barrier insulation, OR
- Radiant GUARD™ **Premium** or **Ultra** radiant barrier insulation

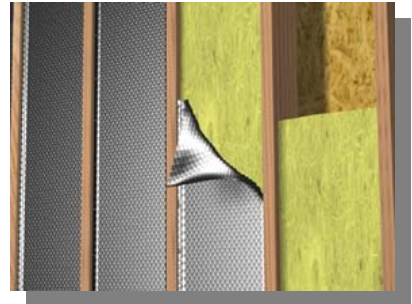

Materials Needed:

- Tape Measure
- Utility knife
- Scissors
- Staple gun and 5/16 staples
- Furring strips

Instructions (2" X 4" with R-13) to achieve Assembly R-Value of 16.0:

1. Install R-13 un-faced insulation per the manufacturer's specifications.
2. Place one corner edge of the bubble insulation in an upper corner of the stud cavity. Staple the product to the side of the stud compressing into the fiberglass $\frac{3}{4}$ ". The edge of the product should be flush with the forward corner of the stud.
3. Proceed "down" stapling to the side of the stud every 2" – 3".
4. Repeat procedure on opposite stud.

Note: The goal is to create a continuous $\frac{3}{4}$ " air space between the product and the interior panel.

An alternate installation method is to staple the bubble insulation to the face of the wall studs and then attach 1" X 2" furring strips over the bubble insulation to which to attach the interior panel.

Instructions (2" X 6" with R-19) to achieve Assembly R-Value of 22.0:

1. Same instructions as above but with 2" X 6" walls studs with R-19 un-faced insulation.